



**OIL & GAS DEVELOPMENT COMPANY LIMITED**  
**PROCUREMENT DEPARTMENT (LOCAL), ISLAMABAD**  
**SCHEDULE OF REQUIREMENT**

Material : **Procurement of Spares for Lube Oil Pumps of RP**

**Due Date:**

Tender Enquiry No: **18492/2021**

**Bid Bond Value : RS.72,000/-**

**EVALUATION WILL BE CARRIED OUT ON FULL PKG.**

**Attachment(if any) : YES**

Sr No	Description	Quantity	Make/Brand offered	Unit	Unit Price (PKR) Inclusive Of All Taxes Except GST	Unit Price (PKR) Inclusive of GST	Total Price (PKR) Inclusive of GST	Delivery Period Offered	deviation from Tender Spec. If Any
1	Casing & Bushing Assembly P 3-213-81L-380-00  Pump Model # KKE4076, Drawing # A5245-1900. Pos# 17 or Equivalent As Per Attached TOR	1		Number					
2	Idler & Bushing Assembly P 3-420-401-080-54 , Pump Model # KKE4076, Drawing # A5245-1900. Pos#27 or Equivalent As Per Attached TOR	1		Number					
3	Idler Pin P 2-435-062-291-00  Pump Model # KKE4076, Drawing # A5245-1900. Pos#30 or Equivalent As Per Attached TOR	1		Number					
4	Mechanical Seal (balanced Viton type) complete P 2-478-229-999-00  Pump Model # KKE4076, Drawing # A5245-1900. Pos#16 or Equivalent As Per Attached TOR	2		Number					
5	Rotor & Shaft Assembly P 3-570-55N-309-24  Pump Model #KKE4076, Drawing # A5245-1900. Pos#26 or Equivalent As Per Attached TOR	1		Number					

**Special Note:** The prospective bidders also download the master set of Tender Document

- The prospective bidders may keep in touch with OGDCL web site for downloading the clarifications/amendments (if any) issued by OGDCL.
- DELIVERY PERIOD: 210 DAYS FROM ISSUANCE OF PO, BID VALIDITY: 120 DAYS FROM THE TECHNICAL BID OPENING DATE.
- PAYMENT TERMS: 100% PAYMENT AFTER DELIVERY, INSPECTION AND INSTALLATION



**OIL & GAS DEVELOPMENT COMPANY LIMITED**  
**PROCUREMENT DEPARTMENT (LOCAL), ISLAMABAD**  
**SCHEDULE OF REQUIREMENT**

**Mandatory Checklist**

Please confirm the compliance of the following mandatory information along with the bid(s) (failing which bids(s) will not be accepted)

Documents	To be Attached with the Technical/Financial Bids	Compliance	
		Yes <input type="checkbox"/>	No <input type="checkbox"/>
Original Bid Bond	Technical Bid	Yes <input type="checkbox"/>	No <input type="checkbox"/>
Copy of NTN Certificate	Technical Bid	Yes <input type="checkbox"/>	No <input type="checkbox"/>
Copy of GST Certificate	Technical Bid	Yes <input type="checkbox"/>	No <input type="checkbox"/>
Confirmation that the Firm is appearing on FBR's Active Taxpayer List	Technical Bid	Yes <input type="checkbox"/>	No <input type="checkbox"/>
Duly signed and stamped <b>Annexure-A (Un-priced)</b>	Technical Bid	Yes <input type="checkbox"/>	No <input type="checkbox"/>
Duly filled, signed and stamped <b>Annexure-B</b>	Technical Bid	Yes <input type="checkbox"/>	No <input type="checkbox"/>
Duly filled, signed and stamped <b>Annexure-D</b>	Technical Bid	Yes <input type="checkbox"/>	No <input type="checkbox"/>
Duly filled, signed and stamped <b>Annexure-L</b> on Company's Letterhead	Technical Bid	Yes <input type="checkbox"/>	No <input type="checkbox"/>
Duly signed and stamped <b>Annexure-M</b> on Company's Letterhead	Technical Bid	Yes <input type="checkbox"/>	No <input type="checkbox"/>
Duly signed and stamped <b>Annexure-N</b> on Non-Judicial Stamp Paper duly attested by Notary Public	Technical Bid	Yes <input type="checkbox"/>	No <input type="checkbox"/>
Duly filled, signed and stamped <b>Annexure-A (Priced)</b>	Financial Bid	Yes <input type="checkbox"/>	No <input type="checkbox"/>
Duly filled, signed and stamped <b>Annexure-C</b>	Financial Bid	Yes <input type="checkbox"/>	No <input type="checkbox"/>
Duly filled, signed and stamped <b>Annexure-E</b>	Financial Bid	Yes <input type="checkbox"/>	No <input type="checkbox"/>



**OIL & GAS DEVELOPMENT COMPANY LIMITED**  
**PROCUREMENT DEPARTMENT (LOCAL), ISLAMABAD**  
**SCHEDULE OF REQUIREMENT**

For the Vendors/Contractors who opt to submit Bank Draft/Call Deposit/Pay order against Bid Bond/Performance Bond, our Accounts Department has finalized an arrangement for online payment to such Vendors/Contractors, which will be processed through (IBFT & LFT) for which following information is required:

i.	IBAN No. (International Bank Account Number 24 Digits)	
ii.	Vendor Name as per Title of their Bank Account	
iii.	Contact No.of Company's CEO/ Owner (Mobile & Landline)	
iv.	Bank Name.	
v.	Bank Branch Name and Code	

Name, Sign and Stamp of the authorized official of the Bidder(s) \_\_\_\_\_

## **Terms of References**

**OGDCL Intends to Procure the Spare Parts for Lube Oil Pump for**

**Pump Model # KKE4076**

**Drawing # A5245-1900**

**Make: Viking Pumps**

1. Bidder must confirm that quoted spare parts are 100% fit in size and function/metallurgy for the Viking Pumps models mentioned by OGDCL. The spare parts to be provided must be from Viking Pumps.
2. Bidders quoting Equivalent parts must provide a Certificate from at least three E&P companies of foreign jurisdiction/ or Pakistani other than bidders/manufacturers own country, stating that equivalent (quoted parts) are used by them and performance of such parts is found satisfactory. Copies of Purchase Orders (unpriced) must also be provided. The certificate(s) / sale record is mandatory and due to non-submission thereof, the bid will be rejected.
3. If bidder found any ambiguity in part nos., it should be cleared prior to bid opening date (Reference Drawing is attached).
4. Parts must be in original OEM (Viking Pumps) Packing.
5. Parts must be new & free from any defect.
6. If bidder found any change/update/superseded part nos., it should be incorporated in bid with OEM (M/S Viking Pumps) confirmation.
7. Parts must have standard OEM (M/S Viking Pumps) warranty/guarantee.
8. Delivery period is 210 days from date of issuance of PO on FOR Dakhni.
9. Bidder must provide the Company profiles & previous supply record (reference list).
10. Bidder must confirm country of origin in technical bid.
11. Bidder should submit the complete compliance of TOR & OGDCL T&C's duly signed and stamped.

**Signed and Seal Stamped TOR**

Sr #	Description	Req QTY	UOM	Country of Origin
1.	Casing & Bushing Assembly P 3-213-81L-380-00  Pump Model # KKE4076, Drawing # A5245-1900. Pos# 17 or Equivalent	1	Number	
2.	Idler & Bushing Assembly P 3-420-401-080-54 , Pump Model # KKE4076, Drawing # A5245-1900. Pos#27 or Equivalent	1	Number	
3.	Idler Pin P 2-435-062-291-00  Pump Model # KKE4076, Drawing # A5245-1900. Pos#30 or Equivalent	1	Number	
4.	Mechanical Seal (balanced Viton type) complete P 2-478-229-999-00  Pump Model # KKE4076, Drawing # A5245-1900. Pos#16 or Equivalent	2	Number	
5.	Rotor & Shaft Assembly P 3-570-55N-309-24  Pump Model #KKE4076, Drawing # A5245-1900. Pos#26 or Equivalent	1	Number	

Signed and Seal Stamped TOR

# VIKING PUMP

Section R710.5  
 Viking Effective Date 11/09/11  
 Distributor Print Date  
 MODEL KKE4076  
 KKE4176

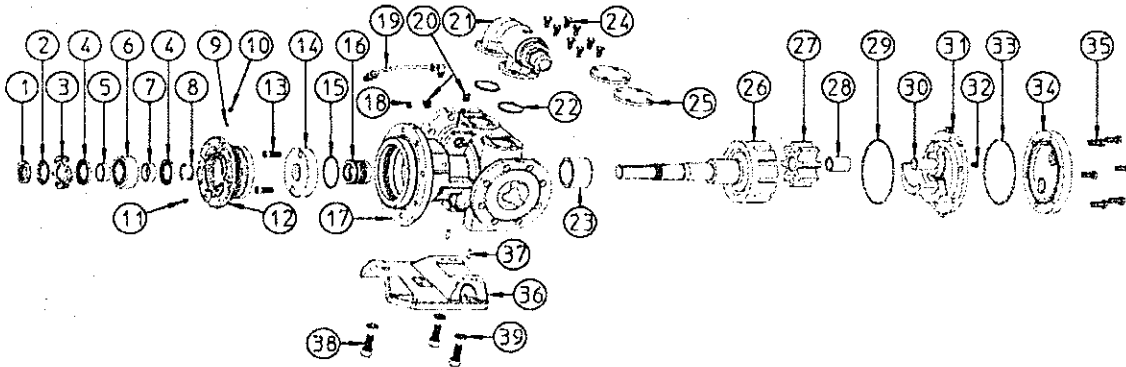

ITEM	PART NO.	DESCRIPTION	MATERIAL	PRICE
1		Locknut	Steel	
2		Lockwasher	Steel	
3		End Cap	Iron	
4		Lip Seal (2 Req'd)	Buna-N	
5		Bearing Spacer Collar (Outer)	Steel	
6		Ball Bearing	Steel	
7		Bearing Spacer Collar (Inner)	Steel	
8		Ring, Half Round (2 Req'd)	Steel	
9		Nylon Slug (2 Req'd)	Nylon	
10		Setscrew, M8-1.25 x 8 mm (2 Req'd)	Steel	
11		Setscrew, M10-1.5 x 14 mm (2 Req'd)	Steel	
12		Bearing Housing	Iron	
13		Capscrews for Seal Plate (2 Req'd)	Steel	
14		Mechanical Seal Plate	Steel	
		Seal Plate; pin type for viscosities over 750 cSt. (3,500 SSU)	Steel	
15		O-Ring for Seal Plate	Buna-N	
			Viton®	
16		Mechanical Seal	Buna-N/Silicon vs Carbon	
			Viton®/Silicon vs Carbon	
		Mechanical Seal; pin type for viscosities over 750 cSt. (3,500 SSU)	Buna-N/Silicon vs Carbon	
			Viton®/Silicon vs Carbon	
17		Casing and Bushing Assembly	Ductile Iron/Carbon Graphite	
18		Grease Fitting 1/8" NPT	Steel	
19		Suckback Line Assembly	Steel	
20		Pipe Plug 1/4" BSP Hex Head (2 Req)	Steel	
21		Relief Valve	Ductile Iron	

# VIKING PUMP

Section R710.5  
 Viking Effective Date 11/09/11  
 Distributor Print Date  
**MODEL KKE4076**  
**KKE4176**

22		† O-Ring Gaskets for Relief Valve / Cover Plates (2 Req'd)	Buna-N	
			Viton®	
23		Bushing (Casing)	Carbon Graphite	
24		Capscrew for Relief Valve/ Cover Plates (8 Req'd)	Steel	
25		Cover Plates (2 Req'd)	Ductile Iron	
26		Rotor and Shaft Assembly	Ductile Iron/Hardened Steel	
27		Idler and Bushing Assembly	Iron/CarbonGraphite	
28		Bushing (Idler)	Carbon Graphite	
29		O-Ring for Head	Buna-N	
		O-Ring for Head, Jacketed	Viton®	
30		Pin, Lube	Hardened Steel	
31		Head and Lube Idler Pin, CW	Ductile Iron/Hardened Steel	
		Head (To Accept Jacket Head Plate) and Lube Idler Pin, CW	Ductile Iron/Hardened Steel	
		Head and Lube Idler Pin, CCW	Ductile Iron/Hardened Steel	
		Head (To Accept Jacket Head Plate) and Lube Idler Pin, CCW	Ductile Iron/Hardened Steel	
32		Pipe Plug 1/4" Bore Square Head	Steel	
33		O-Ring for Jacket Head Plate	Atlas®	
34		Jacketed Head Plate	Ductile Iron	
35		Capscrews, Head	Steel	
		Capscrews, Head (Jacketed)	Steel	
36		(1) Foot	Ductile Iron	
37		(1) Self Locking Pin (2 Req'd)	Steel	
38		(1) Capscrew M16-2 - 1.75 X 40mm (3 Req'd)	Steel - Grade 5	
39		(1) Lock Washer (3 Req'd)	Steel	
1 - 12		Bearing Housing Kit (Complete)	Standard	
36 - 39		(1) Foot Assembly (Complete)	Ductile Iron	