



OIL & GAS DEVELOPMENT COMPANY LIMITED

Request For Quotation (LOCAL)

OGDCL House,
Jinnah Avenue,
Islamabad Pakistan

Header Note: PROCUREMENT OF MECHANICAL SEALS AND REPAIR KITS
Tender Enquiry No: PROC - LH / P T / P & P - 6300000152
Evaluation Criteria: Full Consignment Basis
Bidding Procedure: Single Stage Two Envelope
Vendor: OGDCL CB MODE LOCAL / FOREIGN (1006187)

Due Date:
Bid Bond Value: Rs. 250,000/-
Purchase Req: 30000559
Attachment (If Any): YES

SR#	Material No	Material Description	Unit	Quantity	Make Brand	Unit Price (PKR) Inclusive Of All Taxes Except GST/PST	Unit Price (PKR) Inclusive Of GST/PST	Total Price (PKR) Inclusive of GST/ PST	Delivery Period (Days/Months)	Deviation from Tender Spec. if Any	Plant	
											Plant Code	Plant Name
1.	51-00173	MECHANICAL SEAL APILITE RO-0600-9292 P# 62913 or equivalent	NO	2							0242	UCH FIELD
2.	51-00174	REPAIR KIT FOR MECHANICAL SEAL APILITE RO-0600-9292 P# 66407 or equivalent	NO	4							0242	UCH FIELD

Bid Validity Period: 180 DAYS FROM TECHNICAL BID OPENING DATE
Delivery Period: WITHIN 120 DAYS AFTER ISSUANCE OF PO
Payment Terms: AFTER DELIVERY AND ISNPECTION

For offer	Version: 2
For approval	Date 23.05.2013
Final for delivery	Coordinated: Date
	Approved: Date

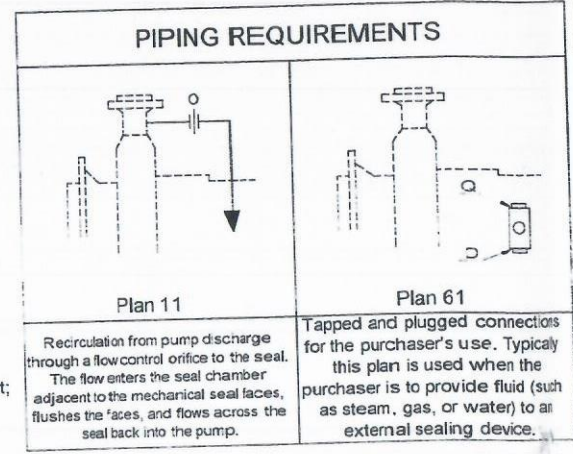
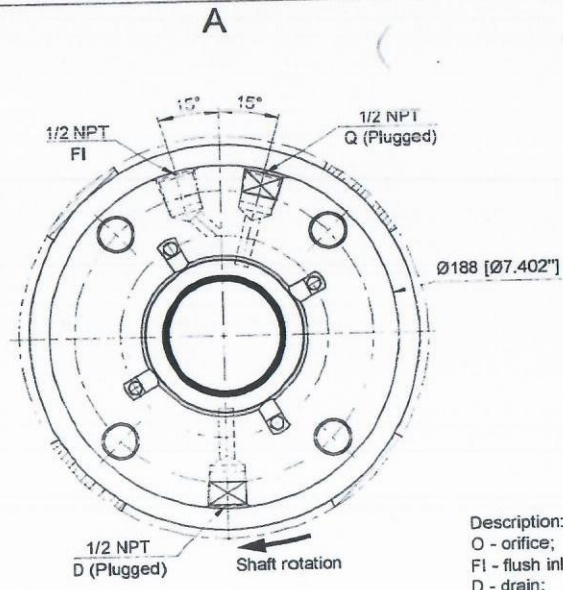
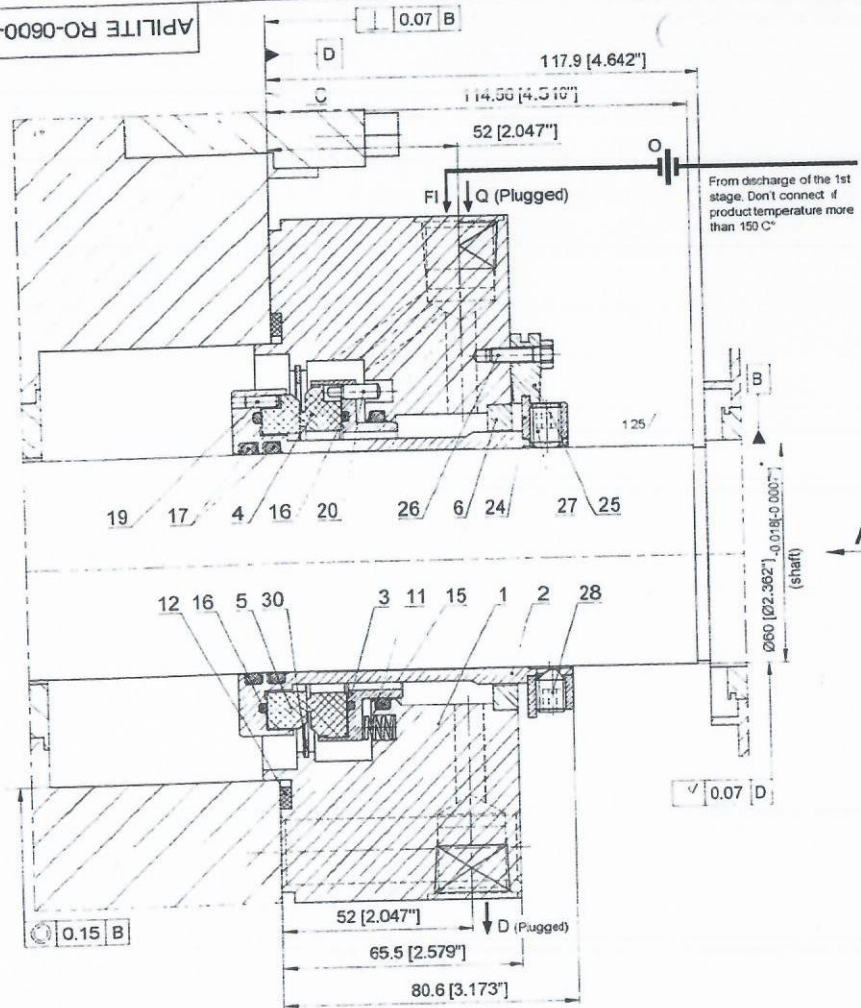

Description:
 O - orifice;
 FI - flush inlet;
 D - drain;
 Q - quench.

CUSTOMER:	Belleli Engineering
Pump Item-No:	300-P104 A/B/C/D
RP-PROJECT No:	160070 A/B/C/D
RP-DRAWING No:	701 480 0034

Customer and equipment data	
1.1 Customer	Belleli Engineering
1.2 End user	Pakistan
1.3 Unit	
1.4 Equipment item number	300-P104 A/B/C/D
1.5 Equipment type	Pump CH2
1.6 Equipment model	SCE 50x10.5
1.7 Project No	160070 A/B/C/D
1.8 Seal Chamber	141200152
1.9 Order N. date	
Working conditions	
2.1 RPM	2980
2.2 Liquid	Lean amine
2.3 Temperature °F	190..200
2.4 Viscosity cP	1.41
2.5 Density, Lb/R³	61.84
2.6 Suction pressure psi g	6.99
2.7 Discharge pressure psi g	79.49
2.8 Seal chamber pressure, psi g	28.72
2.9 Vapor pressure, psi g	9.08
Auxiliary	
3.1 API 682 Plans	11, 61
3.2 Buffer liquid	
3.3 Orifice hole mm	3..4
3.4 Drawing of plans	
Mechanical seal	
4.1 Drawing N	
4.2 Seal Data	
4.3 Data of spare kit	
4.4 Contract invoice	

Item	Part No	Description	Q-ty	Material	Spares	Q-ty
1	62850	Gland	1	AISI316		
2	62851	Sleeve	1	AISI316		
3	46589	Retainer	1	AISI316		
4	62091	Mating ring	1	Resin Carbon	*	1
5	36845	Mating ring	1	S-SiC	*	1
6	35388	Ring	1	Bronze		
11	22273	Spring	6	Hastelloy-C	*	6
12	4293	Gasket	1	AISI316/Graphite	*	1
15	34532	O-Ring	1	Perfluorocelastomer	*	1
16	22767	O-Ring	2	Perfluorocelastomer	*	2
17	34531	O-Ring	2	Perfluorocelastomer	*	2
19	20652	Pin	3	A4		
20	39842	Pin	3	A4		
24	34530	Lock ring	1	2Cr13		
25	20086	Clip	4	2Cr13		
26	24017	Screw	4	A2	*	4
27	4877	Screw	6	A2	*	6
28	14120	Screw	3	A2	*	3
30	27511	Snap ring	1	AISI302	*	1
31	23243	Plug	3	A2		

- Mechanical seal is supplied tested and securely packaged ready for installation.
- * - Check dimensions before installation.
- Before mounting the seal install plugs as required. Use suitable thread sealant such as Loctite-542, PTFE thread sealing ccrd. or similar material.
- Before the installation make sure that the surface C is clean and free of scratches and lugs.
- When tighten nuts of gland studs make sure that the gland fit the surface C of the pump completely without the gap all around the full circle.
- Tighten set screws item 27 equally crosswise, in 4 steps. Final torque: 15 N *m.
- Maximum axial movement (design) ± 2.5 mm.
- Remove clips Item 25 before start-up.
- Do not start-up pump with tank without barrier fluid.
- Install clips item 25, before removing seal.

AS-BUILT

APILITE RO-0600-9292

Mechanical seal
Installation drawing
and parts list

Designed: Fedorova	Checked: Nechporenko	Approved: Horostah
Signature: [Signature]	Signature: [Signature]	Signature: [Signature]
Date: 27.12.12	Date: 27.12.12	Date: 27.12.12

JSC TREM Engineering

Technical Terms & Conditions:

1. Original Authority Letter from OEM (M/S TREM ENGINEERING/EQUIVALENT) for bid submission must be provided with technical bid otherwise bid will be rejected.
2. In case of any ambiguity in part nos., it should be cleared prior to bid submission/opening date.
3. Parts must be in original OEM Packing.
4. Parts must be new & free from any defect.
5. If bidder found any change/update/superseded part nos., it should be incorporated in bid and OEM confirmation be provided with technical bid.
6. Parts must have standard OEM warranty/guarantee.
7. Delivery period is 120 days from date LPO.
8. In case of equivalent parts, Bidder must confirm that quoted spare parts are 100% fit in size and function/ metallurgy (reference drawing provided).
9. In case of equivalent parts, Manufacturer must have 10 years' experience of manufacturing the spare parts for Amine pumps. Company profiles & previous supply record of same parts to E&P Companies (reference list) be provided.
10. Bidder must confirm country of origin in technical bid.
11. Bidder should submit the complete compliance of TOR duly signed and stamped.

12/12/2022
M. AHSAN WAQAR KHAN
Sr. Engr. (Mech)-P&P-NB
Ext. 2004