

**CLARIFICATION AGAINST PROC-FB/CB/PQ/WHA/D-4973/21** Pre-qualification of manufacturers / suppliers for all sizes of wellhead assemblies along with acces ..

Clarification: **“In order to be sure of Customer requirement, we kindly ask to select the preferred option for combination tools threads on attached drawing”.**

OGDCL's Reply: Please note that Option-2 is required as per SOR (Schedule of requirement) i.e. BOX THREAD ON WEAR BUSHING R.R.T. SIDE AND PIN THREAD ON B.O.P. TEST PLUG SIDE (SEE ATTACH DRAWING).

OPTION 1:  
PIN THREAD ON  
WEAR BUSHING R.R.T. SIDE,  
BOX THREAD ON  
B.O.P. TEST PLUG SIDE.

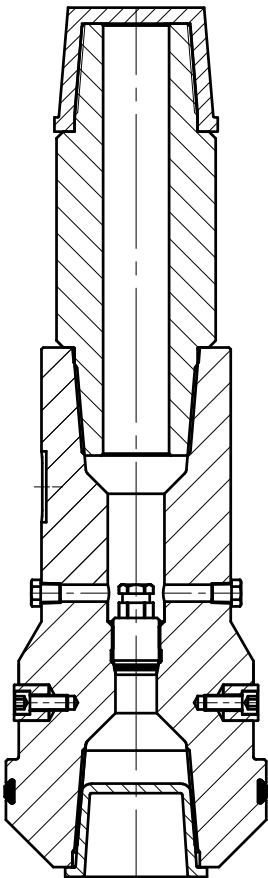

OPTION 2:  
BOX THREAD ON  
WEAR BUSHING R.R.T. SIDE,  
PIN THREAD ON  
B.O.P. TEST PLUG SIDE.

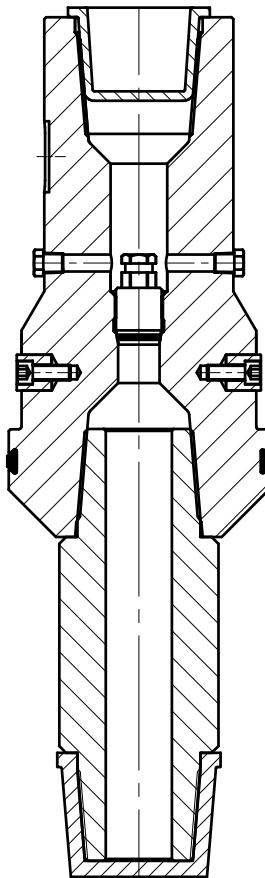

OPTION 3:  
PIN THREAD ON BOTH  
WEAR BUSHING R.R.T. SIDE,  
AND B.O.P. TEST PLUG SIDE.

