

INTERIOR DESIGN OF ADDITIONAL ROOMS

PREPARATION OF DETAILED DESIGN, COST ESTIMATE & BOQ FOR
CONSTRUCTION OF CUBICLES / SMART WORK PLACE AND CONFERENCE ROOM
IN OPEN AREAS & ADDITIONAL ROOMS INSIDE TOWERS A, B, C & D ON 3RD
FLOOR, OGDCL HOUSE, ISLAMABAD

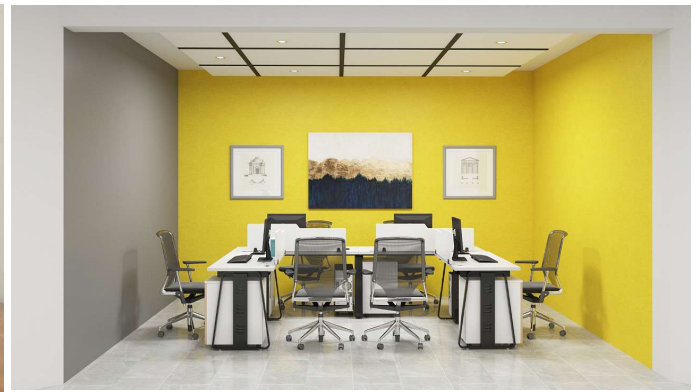

CLIENT:



OIL & GAS DEVELOPMENT
COMPANY LIMITED ISLAMABAD

CONSULTANT:



ARCH-TECH ENGINEERING
CONSULTANT PVT LTD

Office Address: Office No. 02, Lower Ground, Al- Safa Heights 2, F-11 Markaz, Islamabad.
Email: arch_tech@live.com, web: www.arcteceng.com, Contact: +92 321 9003632, 342 9673189

TOWER-A ADDITIONAL ROOM:

PLAN

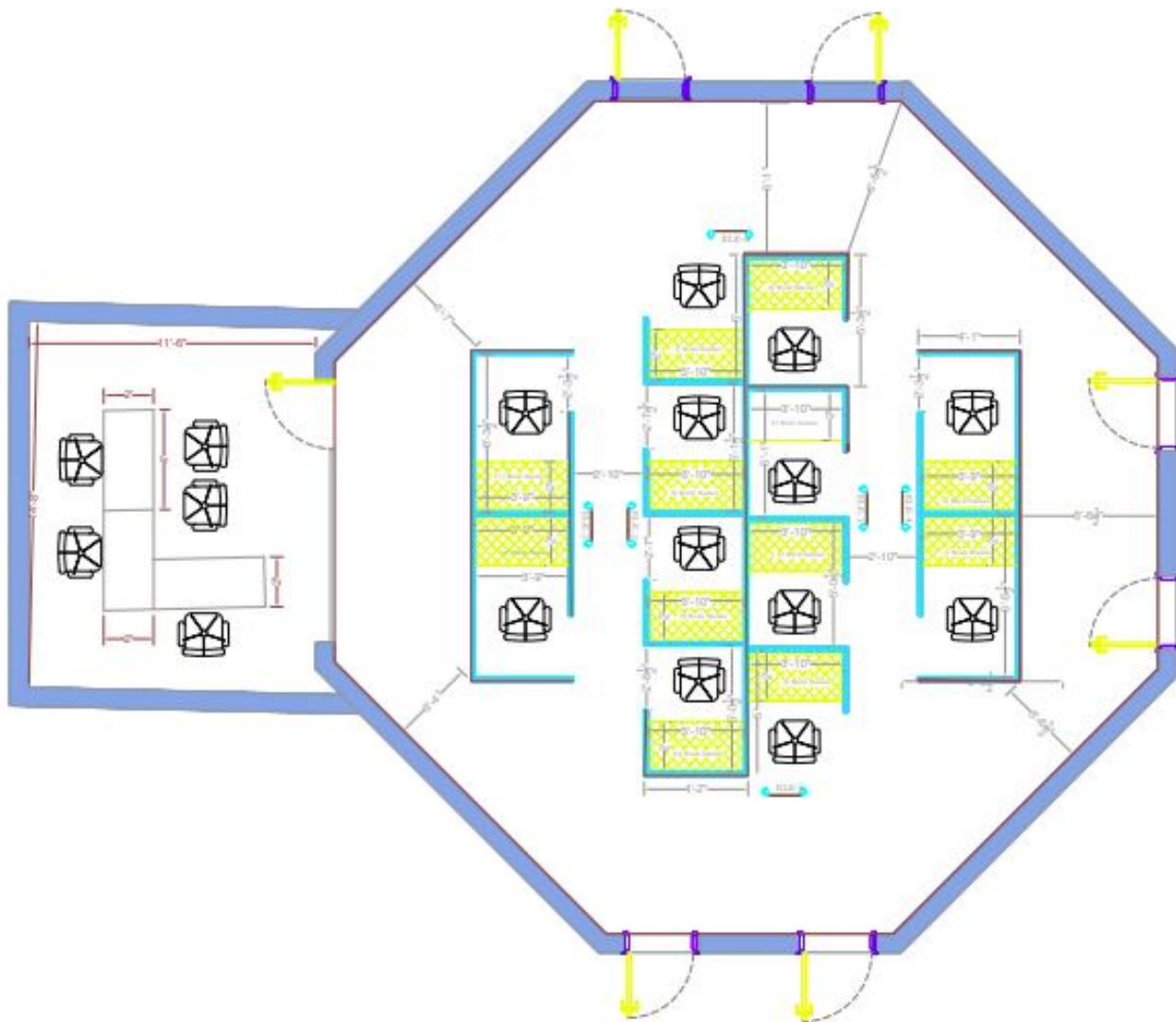

Tower A Linked
Additional Room

3D DESIGN VISUALS



TOWER-A ADDITIONAL ROOM

**Office Address: Office No. 02, Lower Ground, Al- Safa Heights 2, F-11 Markaz, Islamabad.
Email: arch_tech@live.com, web: www.arcteceng.com , Contact: +92 321 9003632, 342 9673189**

TOWER-B ADDITIONAL ROOM:

PLAN

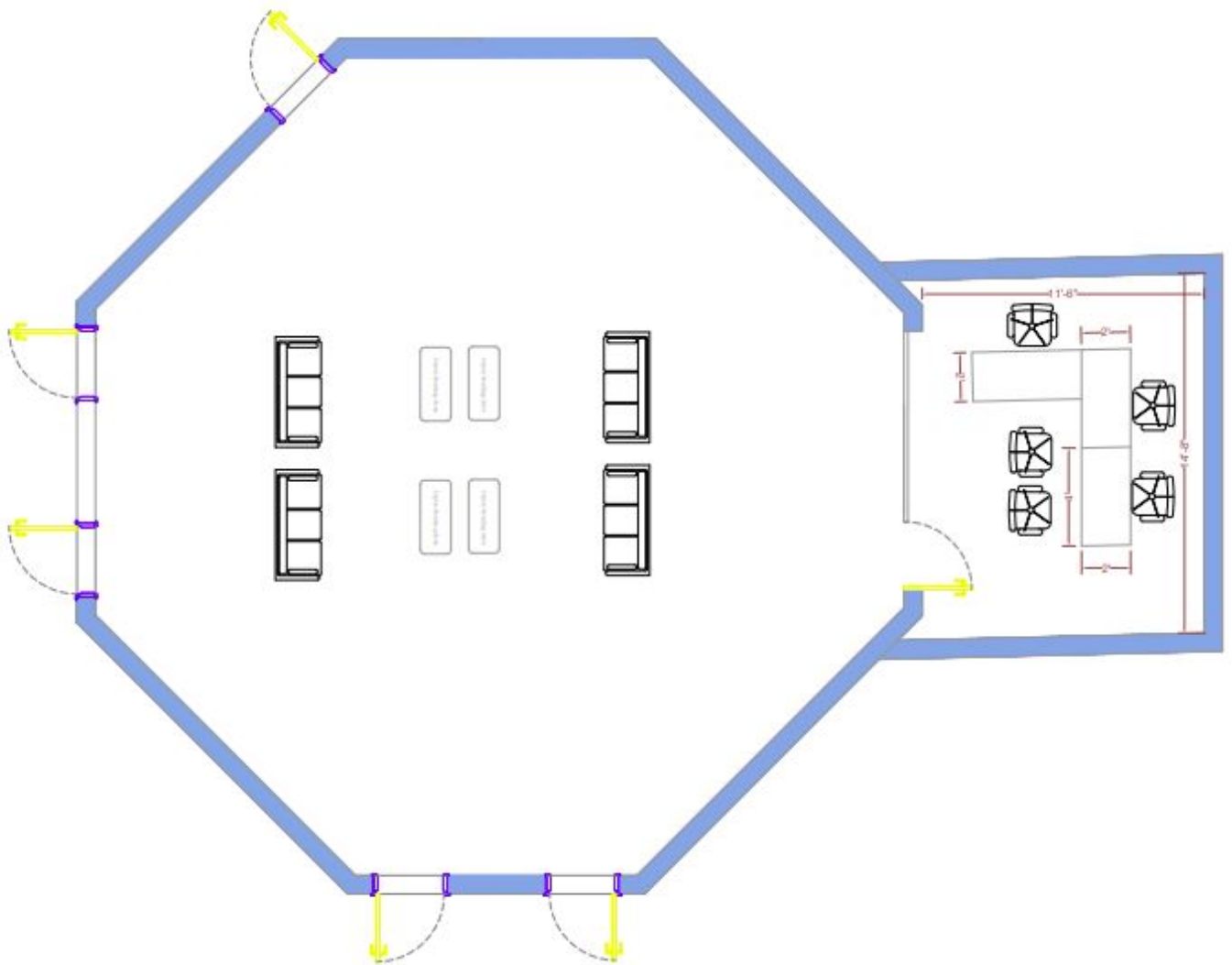

Tower B Linked
Additional Room

3D DESIGN VISUALS



TOWER-B ADDITIONAL ROOM

Office Address: Office No. 02, Lower Ground, Al- Safa Heights 2, F-11 Markaz, Islamabad.
Email: arch_tech@live.com, web: www.arcteceng.com , Contact: +92 321 9003632, 342 9673189

TOWER-C ADDITIONAL ROOMS:

PLAN

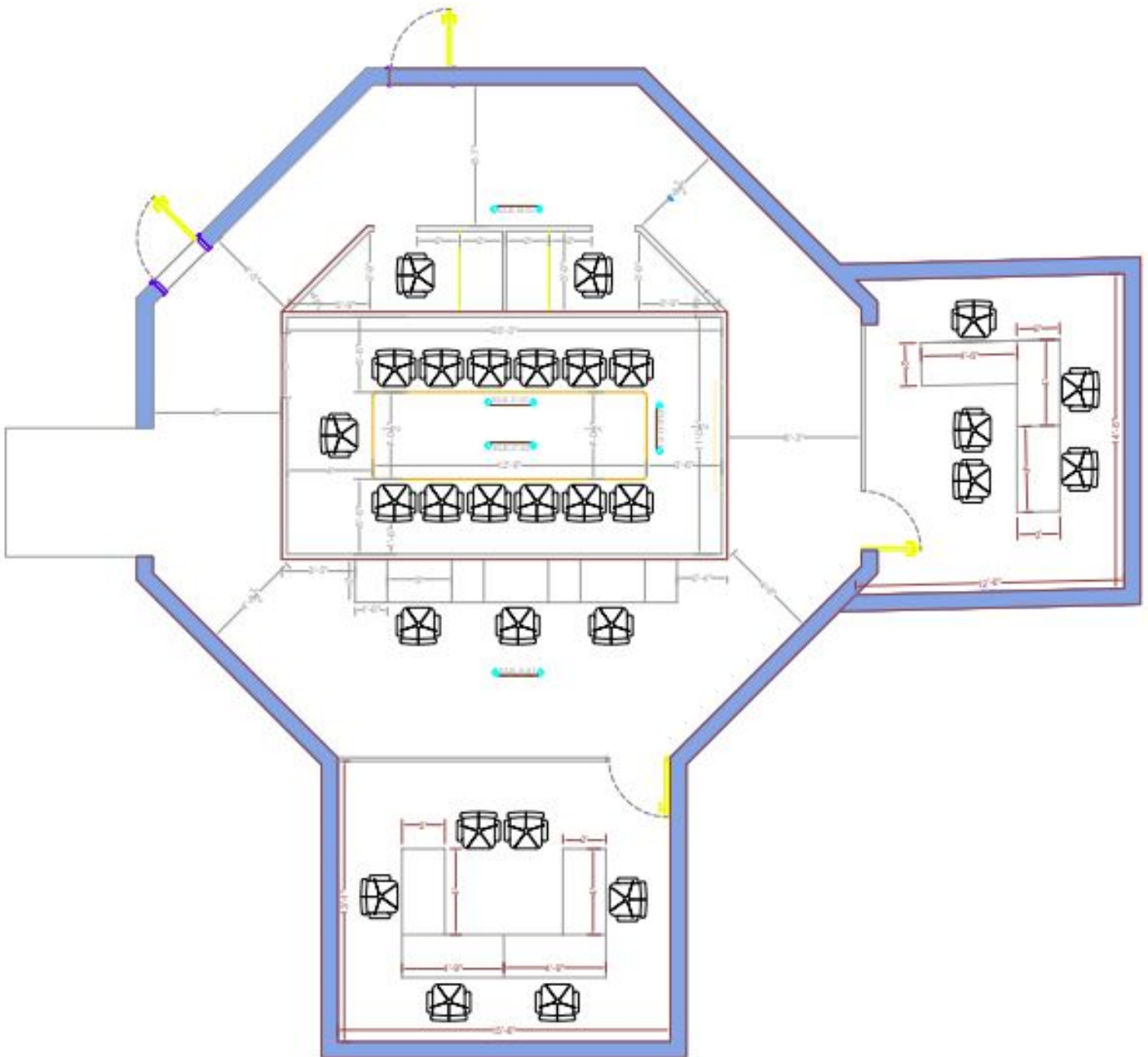

Tower C Linked
Additional Rooms

3D DESIGN VISUALS



TOWER-C ADDITIONAL ROOM-1

3D DESIGN VISUALS



TOWER-C ADDITIONAL ROOM-2