



OIL & GAS DEVELOPMENT COMPANY LIMITED

Request For Quotation (LOCAL)

OGDCL House ,
Jinnah Avenue,
Islamabad
Pakistan

Header Note: WORK STATIONS

Tendor Enquiry No: 6300000105 / SCM LOCAL /296 / I 9 Base Store / 2022

Evaluation Criteria: Full Consignment Basis

Bidding Procedure: Single Stage Two Envelope

Vendor:

Bid Bond Value: Purchase Req: Rs. 45,100.00

Attachment (If Any): 30000128

YES

| SR# | Material Description | Unit | Quantity | Make Brand | Unit Price (PKR) InclusiveOfAll Taxes Except GST/PST | Unit Price (PKR) Inclusive Of GST/PST | TotalPrice (PKR) Inclusive of GST/PST | Delivery Period (Days/Months) | Deviation from Tender Spec. if Any | Plant | |
|-----|---|------|----------|------------|--|---------------------------------------|---------------------------------------|--------------------------------|------------------------------------|------------|----------------|
| | | | | | | | | | | Plant Code | Plant Name |
| 1. | Workstation surface Material (25)mm linch thick compressed wood E1 Grade with a maximum content up to 12% confirming to specs as internationalstandards Workstation for 4 Persons (size 8#x4#) . | NO | 2 | | | | | | | 0111 | I 9 Base Store |
| 2. | Workstation surface Material (25)mm linch thick compressed wood E1 Grade with a maximum content up to 12% confirming to specs as internationalstandards Workstation for 2 Persons (size 5#x4#) . | NO | 5 | | | | | | | 0111 | I 9 Base Store |

| | | | | | | | | | | |
|----|--|----|---|--|--|--|--|--|------|----------------|
| 3. | Workstation surface Material (25)mm linch thick compressed wood E1 Grade with a maximum content up to 12% confirming to specs as internationalstandards Workstation for 1 Persons (size 5#x4#) . | NO | 1 | | | | | | 0111 | I 9 Base Store |
| 4. | Meeting Table Surface Material (25)mm1 inch thick compressed wood E1 Gradewith a maximum content up to 12% confirming to specs as international standards. LENGTH OF CONFERENCE TABLE=15 FEET | NO | 1 | | | | | | 0111 | I 9 Base Store |

Bid Validity Period: 120 DAYS
Delivery Period: 60 DAYS AFTER ISSUANCE OF LPO
Payment Terms: AFTER DELIVERY & INSPECTION

ROOM 1003-1004 LAYOUT

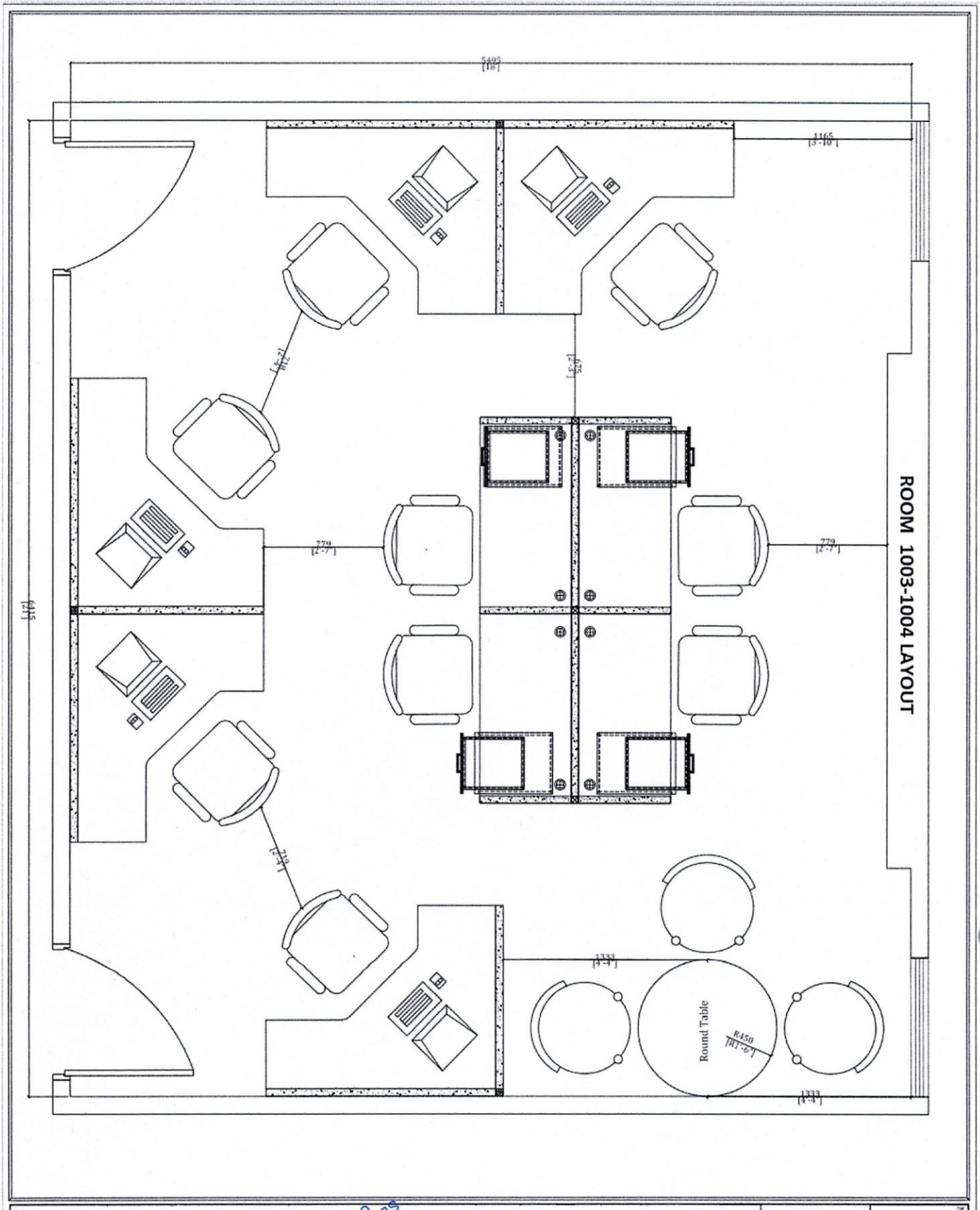

4115

5405

1165

244

231

279

279

238

133

1337

Round Table
R450
181-67

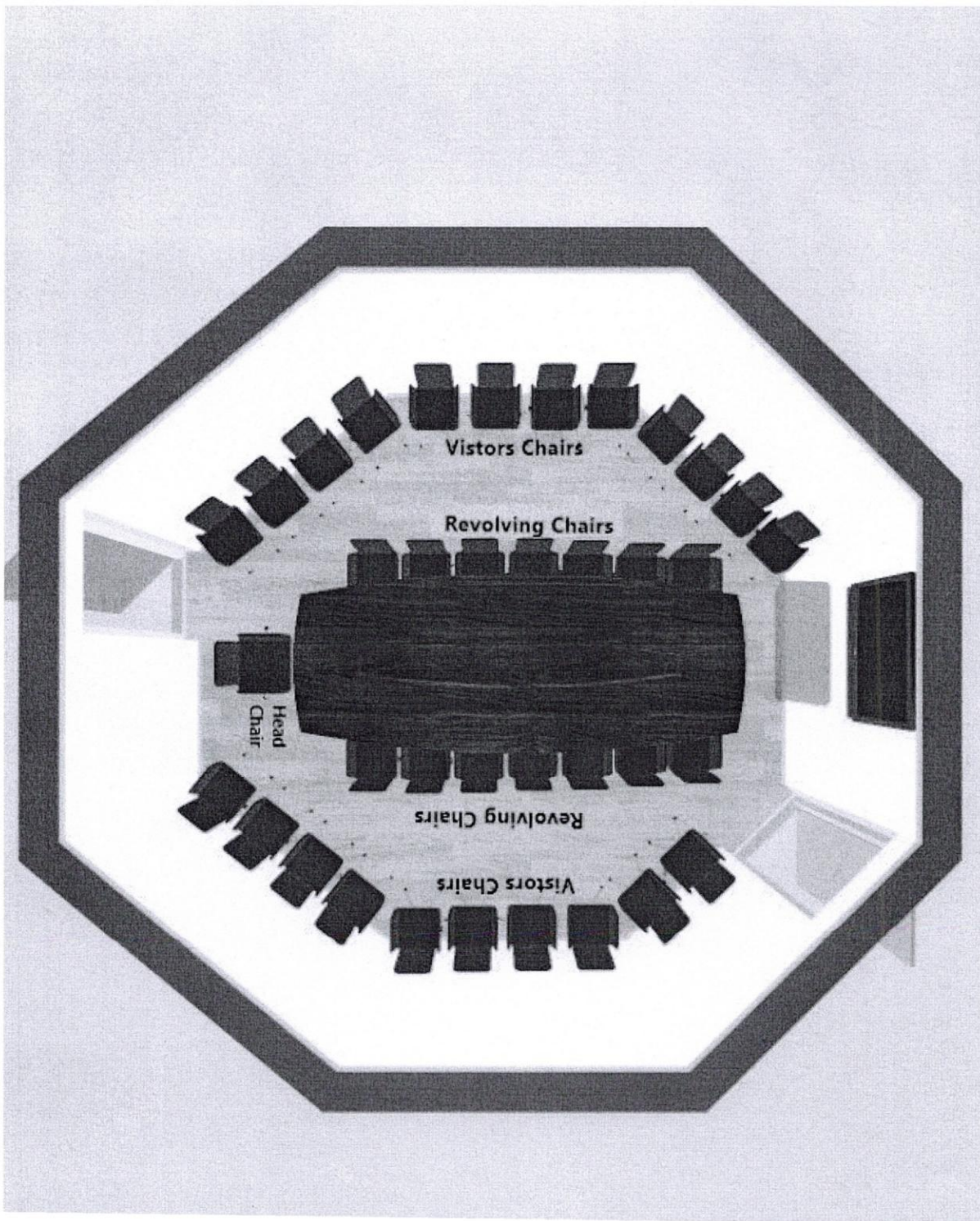

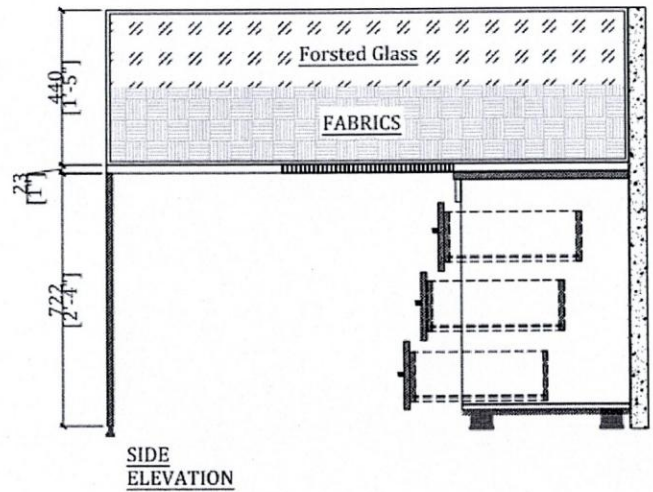
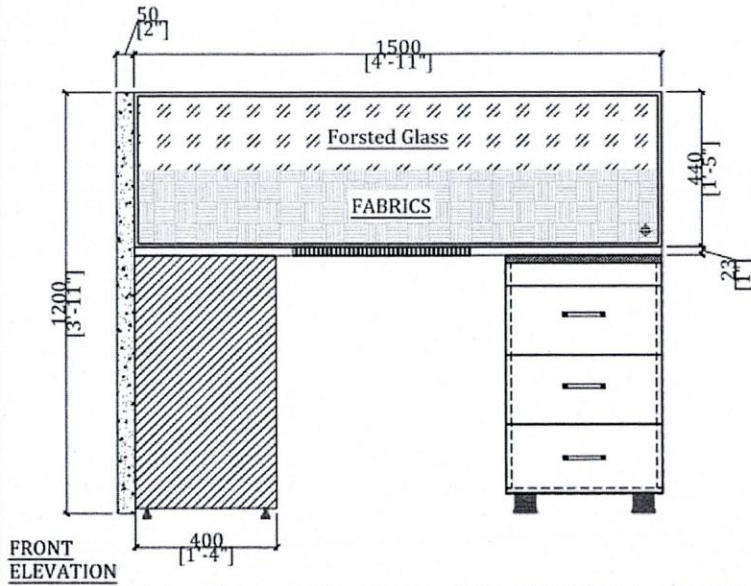
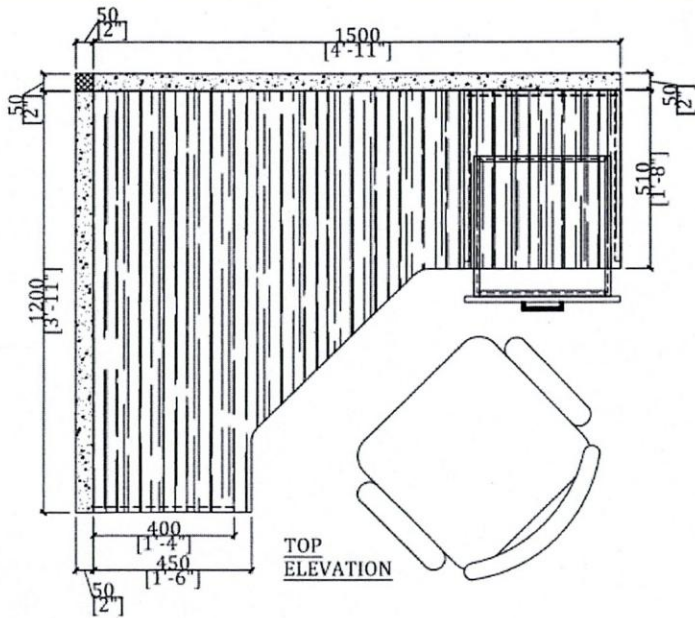

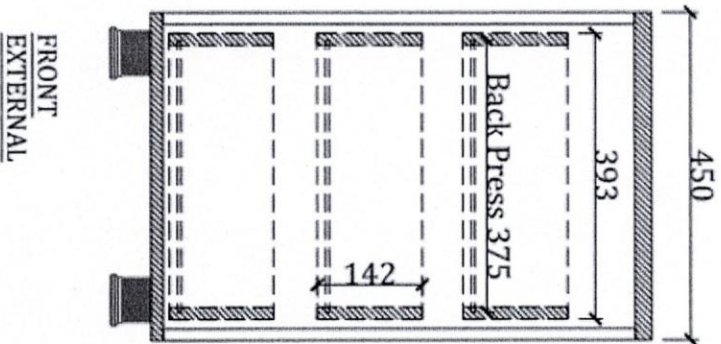
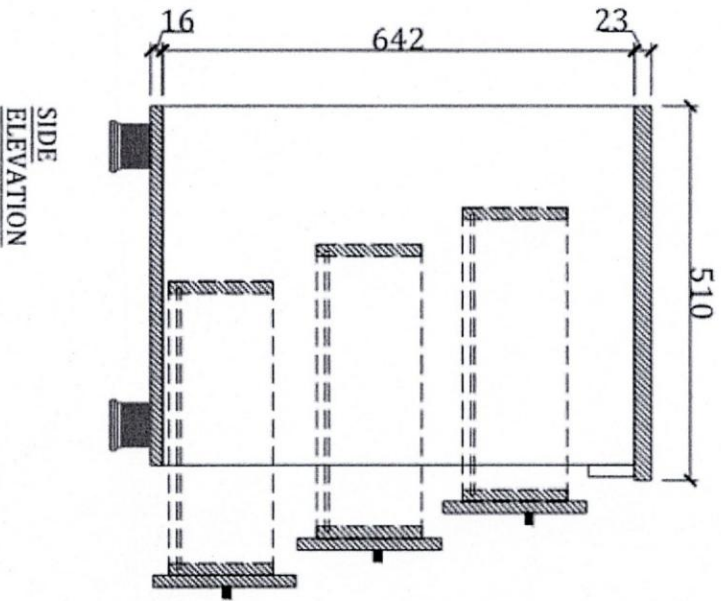
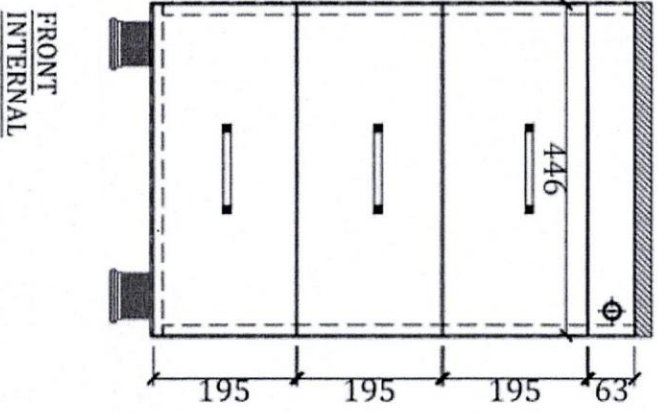
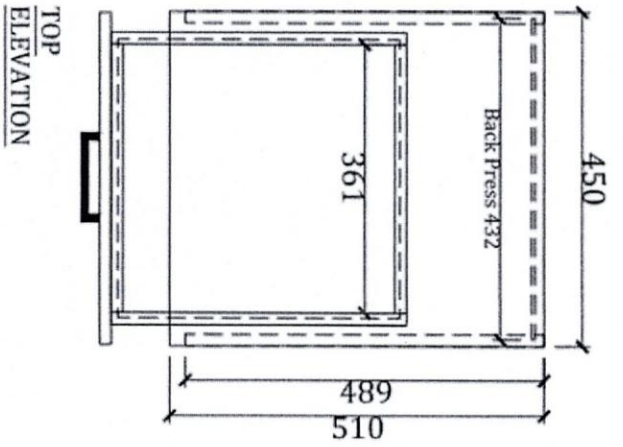

Tender Terms & Conditions

Technical Proposal should be submitted covering the following details;

- Brief company profile with years of service experience in the same field.
- Bidder must have workshop/manufacturing facility in Pakistan.
- List of clients where bidder has provided the same nature of services.
- Bidder must provide piece of sample wood being used at the time of bid submission. Quality of wood would be checked/analyzed by technical team, who can reject the bid in case of low/cheap quality material.
- Bidder must deliver the furniture in 7-8 weeks.

Otherwise bid May be rejected.