

OIL & GAS DEVELOPMENT COMPANY LIMITED
PROCUREMENT DEPARTMENT, ISLAMABAD
FOREIGN SECTION E

(To be completed, filled in, signed
and stamped by the principal)

ANNEXURE 'A'

Material MOTOR STARTER PANEL (EXPLOSION PROOF TYPE) FOR DAKHNI PLANT
Tender Enquiry No PROC-FE/CB/P&P/DKN-3197/2018
Due Date
Evaluation Criteria FULL

SCHEDULE OF REQUIREMENT

Sr No	Description	Unit	Quantity	Unit Price (FOB)	Total Price (FOB)	Unit Price C & F BY SEA	Total Price C & F BY SEA	Deviated From Tender Spec. If Any
1	Motor starter panel (Explosion proof type) for Hazardous area IP-66, Zone I, Class-I, T4, EExia, for complete details please see attachments.	Number	1					

Note:

- 1. Bid bond:** Pursuant to tender clause # 2.2, 11.4, 13 & 35.3.2, bid bond amounting USD 600/- (USD Six Hundred only) or equivalent in Pak Rupees should be submitted with the technical bid.
- 2. Evaluation Criteria:** FULL CONSIGNMENT WISE ON CFR KARACHI BASIS
- 3. Shipment from ACU member Countries:** In case of shipment from ACU member countries, the LC beneficiary should be of that particular country from where the consignment is being shipped.
- 4. Terms and conditions:** Bidders are advised to carefully read all the terms and conditions of the Tender Document available at OGDCL website in the master tender document and attached technical Terms & Conditions.
- 5. Delivery period:** 120-day after establishment of L/C.

Vetted
S. B. I.
 SYED RIZAL AHMAD
 Dy. Chief Insp. (Insc.)
 P&P-N. Dkt. 2705

NO	NAME	MODEL	QTY	EQUIPMENTS
1	WCS	144 250 Dlg R250 FT 3P	1	ABQ 250A / 30 38KA
2	WCS	118 150 Dlg R125 FT 3P	2	ABQ 125A / 30 38KA
3	WCS	126 150 Dlg R150 FT 3P	2	ABQ 150A / 30 38KA
4	AC Contactor (KW)	LC-095 DVC	2	Schneider 380V AC
5	AC Contactor (KW)	LC-095 DVC	2	Schneider 380V AC
6	Electric resistor	LCR 7120	4	Schneider 380V AC
7	Thermal relay (A)	TR133 R3C	2	Schneider (63-80A)
8	Thermal relay (A)	TR100 05 T	1	Schneider (2.5-4A)
9	Thermal relay (A)	TR100 06 T	1	Schneider (1-1.6A)
10	Ammeter	BA8050A-2M	1	2 times overload
11	Ammeter	BA8050A-5M	1	2 times overload
12	Ammeter	BA8050A-10M	2	2 times overload
13	Current Transformer	LA2M-100/1	2	
14	Voltage meter	BM3550A-400 V	1	
15	fuse	R18-2A	9	
16	Switch switch	SK	2	
17	Resistor	RA	12	4R44747
18	Inductor	RI	10	4R3543V 380VAC
19	terminals	MT120	2	
20	terminals	MT10	8	Washmiller
21	terminals	SK43N	30	Washmiller
22	Exposure-proof glass	BAZ-7 AR3XYS	2	Aluminium alloy
23	Exposure-proof glass	1-153812-440816-1238	2	DCM-II Ex-d

GENERAL NOTE

Technical requirements:
 1. Enclosure in made of Aluminium Alloy, Powder Coated,RAL7010
 2. Internal & external earth.
 3. Ex-proof, IPI 2 G Ex d IIB T4
 4. Degree of protection IP55.
 5. Ambient temperature: -50°C ~ +55°C.
 7. Internal Wire: 300V/1000V grade.
 colour : L(Yellow), L2(Green), L3(Grey) for Phase & yellow/green for ground.
 8. #10 Steel channel : Carbon steel, powder coated RAL7010.
 9. Cond. DCM-II, nickel plated brass, armored cable wiring, with shroud, sealing washer.
 M25BX1.5, plate: #25mm-#41mm, outlet: #25mm-#32mm, M40BX1.5, plate: #22mm-#35mm, outlet: #19mm-#25.5mm, M25BX1.5, plate: #12.5mm-#20.5mm, outlet: #10mm-#14.5mm.

QTY: 1

SYED BILAL AHMAD
 (In- Charge Engr (Inst.)
 P&P-N, Engr-2705

Lot No 587

Page 2/1

ON. G.W.

NO	NAME	MODEL	REMARKS	QTY
1	WCB	14N 250 IND R250 FT 3P	ABB, 250A/3P,38KA	1
2	WCB	11N 150 IND R125 FT 3P	ABB, 125A/3P,38KA	2
3	WCB	12N 150 IND R10 FTCL 3P	ABB, 10A/3P,38KA	2
4	AD Contactor (KW)	LC1-D95 07C	Schneider, 380V AC	2
5	AD Contactor (KM)	LC1-D95 07C	Schneider, 380V AC	2
6	Thermal relay (R)	LRD 075U	Schneider, 380V AC	4
7	Thermal relay (R)	LRH33 B3C	Schneider, (63-80A)	2
8	Thermal relay (R)	LRD 08 C	Schneider, (2.3-4A)	1
9	Thermal relay (R)	LRD 08 C	Schneider, (1-1.6A)	1
10	Ammeter	BB950X1-2A	2 times overload	1
11	Ammeter	BB950X1-5A	2 times overload	1
12	Ammeter	BB950X1-10A	2 times overload	2
13	Current transformer	LZM1-H0/1		2
14	Voltage meter	BB950X1-0-400 V		1
15	Fuse	K11B-7A		9
16	Select switch	HK		4
17	Pushbutton	HA	4R140447	12
18	Indicator	HD	4R13K131, 380VAC	10
19	Terminal	WT120		4
20	Terminal	WT10		8
21	Terminal	SARKEN	Welding bar	30
22	Explosion-proof seal bushing	BA9-2 MAX15	Aluminium alloy	2
23	Explosion-proof gland	1-M50B72-M40B16-M28U	DGM-II, EX-D	

GENERAL NOTE

Technical requirements
 1. Enclosure is made of Aluminium Alloy, Powder Coated,RAL 7040
 2. Internal & external earth, 3x- mark, 2 G Ex d IIB 16 Db.
 3. Ambient temperature: -55°C ~ +55°C
 4. Degree of protection: IP66.
 5. Ambient temperature: -50°C ~ +55°C
 7. Internal Wt: 600/1000V grade.
 Colour: L(brown), L2(black), L3(grey) for Phase & yellow/green for ground.
 8. F10 Steel channel - Carbon steel, powder coated RAL7040.
 9. Gnd: DGM-II, nickel plated brass, armored cable wiring, with shield, sealing washer.
 M50B1.5, inlet: 225mm-41mm, outlet: 225mm-32mm.
 M40B1.5, inlet: 125mm-43mm, outlet: 125mm-25mm.
 M25B1.5, inlet: 75mm-320mm, outlet: 100mm-41.5mm.

QTY

1

Vetted
S.B.

ENGR. BELAL AHMAD
of Engr. (Inst.)
P.E.-N. Ext: 2705

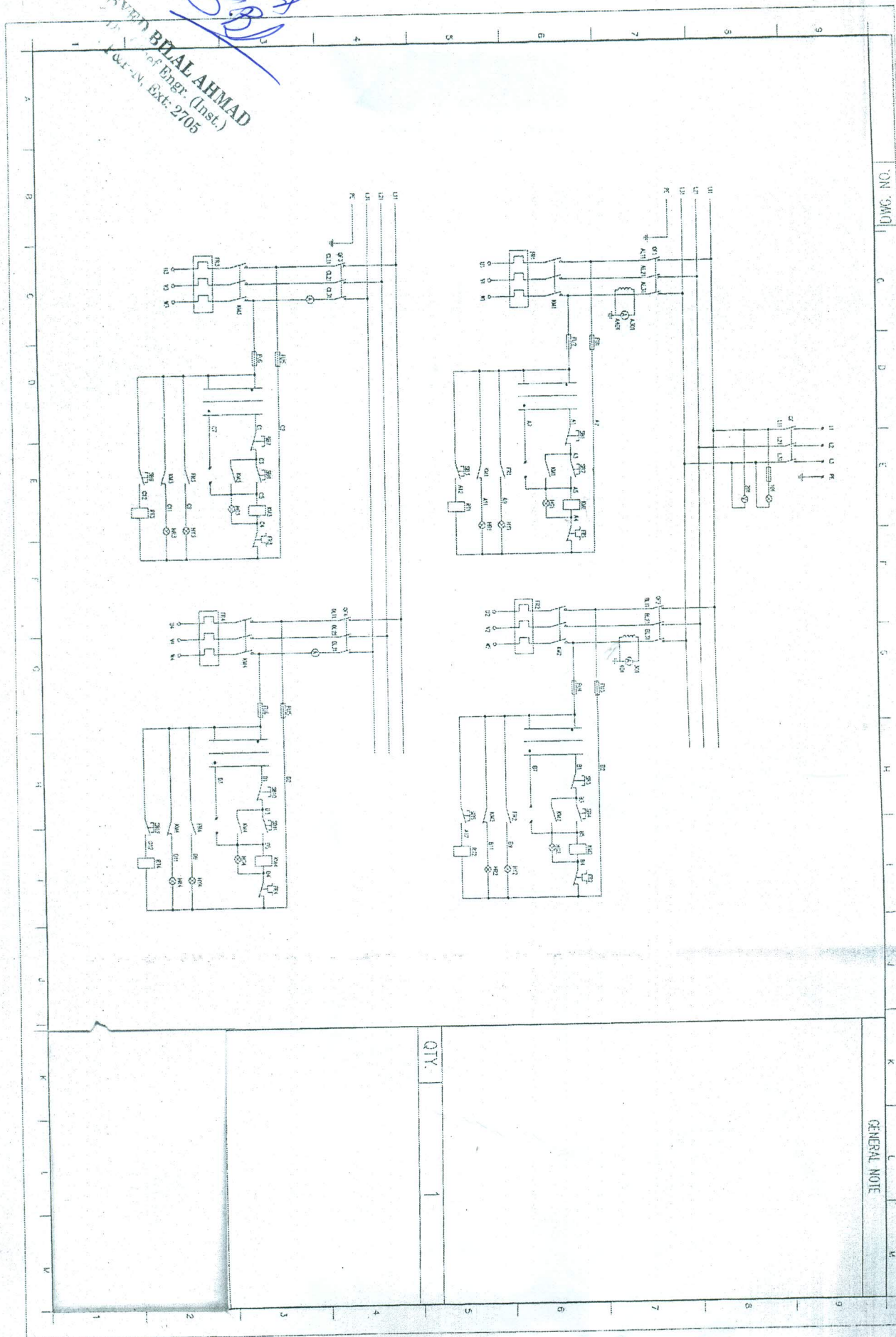

DWG. NO.

GENERAL NOTE

QTY

1

Vettel
S.B.
SYED BILAL AHMAD
Dy. Chief Engr. (Inst.)
P&P-N, Exe. 2705

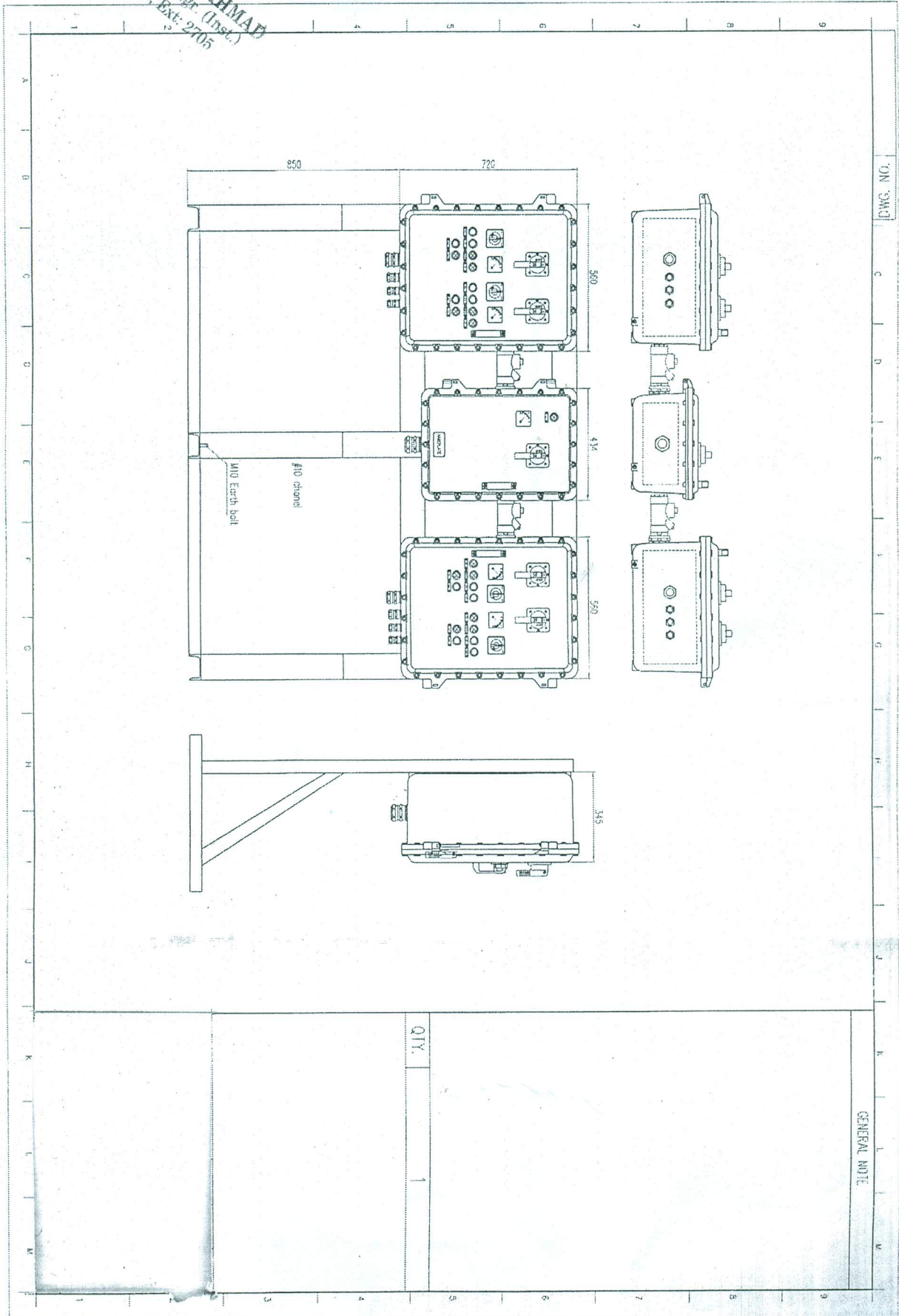

Veths
SYED BILAL AHMAD
 Dy. Chief Engr. (Inst.)
 P&P-N, Ext: 2705

EXPLOSION PROOF TYPE MOTOR STARTER PANEL FOR HAZARDOUS AREA.

Supply of (01) number complete Free Standing Field Mounted Explosion Proof Type IP-66 Motor Starter Panel for Hazardous Area. Motor Starter Panel shall be suitable for outdoor installation in Hazardous Area Zone'I, Class-I, Division-I, Cat-I, Group-I, T4, IP-66, Intrinsic Safety EEx'ia', ambient temperature 50°C.

The (3-Phase 4- Wire) panel shall consist of (04) outgoing motor starters, internally pre-wired for 380VAC, 3Pole, 50 Hz. The (04) outgoing motor starters must include separate ampere meters, Auto/Off/Manual selector switches, motor Start, Stop, Trip indications, Trip Reset Push buttons, magnetic contractor and thermal overload each for individual motor starter.

The Panel shall have voltmeter and power "ON" indication on incomer.
 Further (01) number main incomer MCCB type circuit breaker 225 amp, 3-pole.
 (02) Nos separate MCCB 150 amp each, 3 Pole for 37KW each (main and standby) motors and
 (01) MCCB 10 amp, 3 Pole for 1.5 KW motor and
 (01) MCCB 6 amp, 3 pole for 0.75KW motor.

Note. All circuit breaker shall be operatable form outside of panel.

Panel shall include explosion proof (Ex'd), IP65/66 Brass Type cable glands with shroud, lock nut, washer and all accessories suitable for 600/1000 V for following power and control cables.

1. 95 mm sq, 4 Core, CU/XLPE/SWA/PVC incomer power cable.
2. 70 mm sq, 3 Core, CU/XLPE/SWA/PVC outgoing power cable for 37 KW main motor A.
3. 70 mm sq, 3 Core, CU/XLPE/SWA/PVC outgoing power cable for 37 KW standby motor B.
4. 1.5 mm sq, 7 Core, CU/PVC/PVC/SWA outgoing control cable for 37KW main motor A.
5. 1.5 mm sq, 7 Core, CU/PVC/PVC/SWA outgoing control cable for 37 KW main motor B.
6. 4 mm sq, 3 Core, CU/XLPE/SWA/PVC outgoing power cable for 1.5 KW motor A.
7. 4 mm sq, 3 Core, CU/XLPE/SWA/PVC outgoing power cable for 0.75 KW motor B.
8. 1.5 mm sq, 7 Core, CU/PVC/PVC/SWA outgoing control cable for 1.5 KW motor A.
9. 1.5mm sq, 7 Core, CU/PVC/PVC/SWA outgoing control cable for 0.75 KW motor B.

The incoming and all outgoing power and control cables entries shall be from bottom side only.

TOR.

1. Supplier shall provide panel drawings.
2. Supplier shall provide wiring diagram of panel.
3. Supplier shall provide list with part Nos, make, installed quantities, detail of all installed items /spares.
4. Certificate that material is according of requirement and suitable for hazardous area
5. Certificate that supplied material /panel is free from any manufacturing defect.
6. Damaged / faulty panel will not be acceptable.
7. Inspection will be carried out at site. Damaged or faulty components will be replaced by the supplier free of chargers at own his expense.
8. ~~Supplier shall provide list with part Nos, make, installed quantities, detail of all installed items /spares.~~

J.R